

VERTICAL TYPE SWITCHES | SLIDE SWITCHES

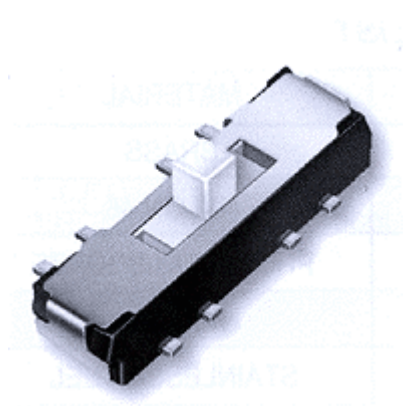

[1380T]

Typical Specifications

1. Rating : DC 6V 0.3mA
2. Circuit : 1C-3P
3. TIMING : NON-Shorting
4. Travel : 2+2mm
5. Operating Force : a->b, c->b: 120 ± 100 gf
b->a, b->c: 250 ± 100 gf
6. Operating Life : 10,000 Cycles

PART	MATERIAL
TERMINAL	BRASS
CASE	NYLON 46
CLIP	PHOSPHOR-BRONZE
SLIDER	NYLON 46
COVER	STAINLESS-STEEL

Features

- ▶ 2mm Travel
- ▶ Reflow-soldering type
- ▶ Available for tape and reel package

Application

- ▶ Function and band selector switches for headphone stereo sets, liquid-crystal TV sets, car radio, camera VCRs, memory cards, etc.

OUTLINE DRAWING

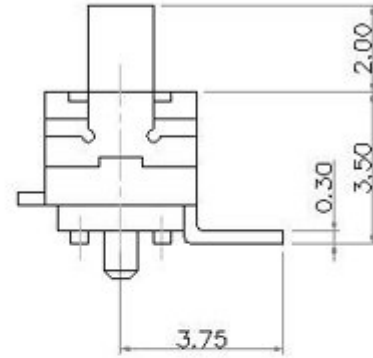
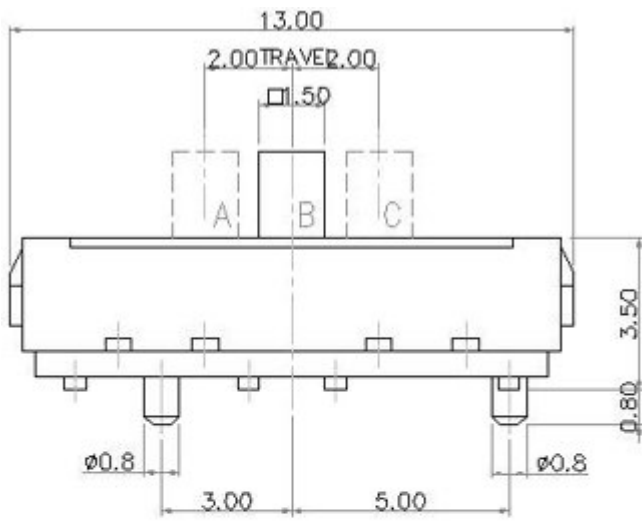

P.C.B LAND PATTERN

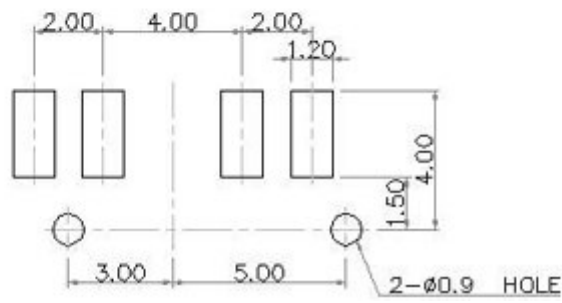

CIRCUIT DIAGRAM

