

[1114U]

Typical Specifications

1. Rating : DC12V 50mA
 2. Travel : 0.3 ± 0.1 mm
 3. Contact Resistance : 100m Ω Max.
 4. Bounce : 10m SEC MAX.
 5. Operating Force
 - * 1114U-2 : 180 ± 50 gf [100,000Cycle]
 - * 1114U-3 : 250 ± 50 gf [100,000Cycle]
- ▶ Long life and excellent operation feeling by use of a super small-sized round-shaped movable contactor
 - ▶ High contact reliability through sealed terminals
 - ▶ High mountability by u-bent terminals
 - ▶ Available for tape and reel package
 - ▶ Signal input switch for mobile communication equipment. audio visual equipment. office automation equipment

OUTLINE DRAWING

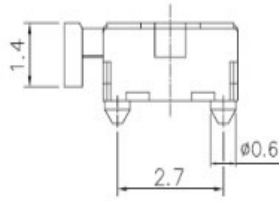
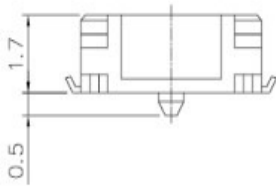
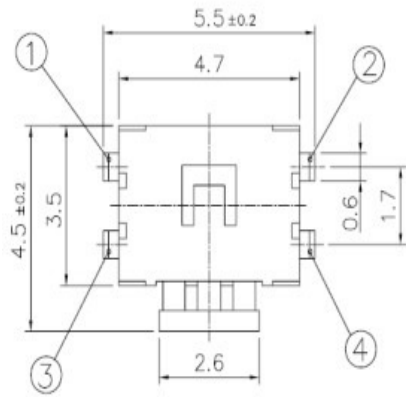

CIRCUIT DIAGRAM

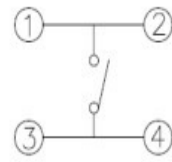

P.C.B MOUNTING HOLES

