

## [1107GU]

---

### Typical Specifications

1. Rating : DC12V 50mA
  2. Travel :  $0.25 \pm 0.1$ mm
  3. Contact Resistance : 100m $\Omega$ Max.
  4. Bounce : 10m SEC MAX.
  5. Operating Force
    - \* 1107GU-1 :  $130 \pm 30$ gf [50,000Cycle]
    - \* 1107GU-2 :  $180 \pm 50$ gf [50,000Cycle]
    - \* 1107GU-3 :  $250 \pm 50$ gf [30,000Cycle]
- ▶ 6.1 \* 3.7mm square thin type:2.5mm in height
  - ▶ Excellent clear click feeling due to tactile feedback characteristic.
  - ▶ Reflow soldering applicable
  - ▶ Dust proof construction
  - ▶ Available for tape and reel package
  - ▶ Operating push-button switches for portable CD players

# OUTLINE DRAWING

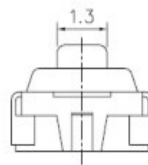
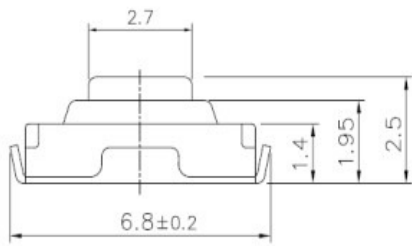
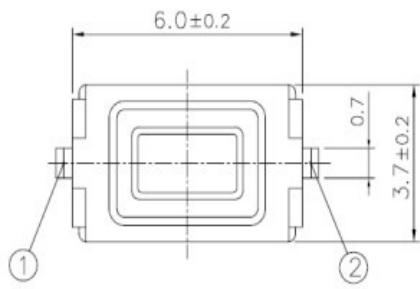

# CIRCUIT DIAGRAM



# P.C.B LAND PATTERN

