

SMD TYPE SWITCHES | TACT SWITCHES

[1101NH]

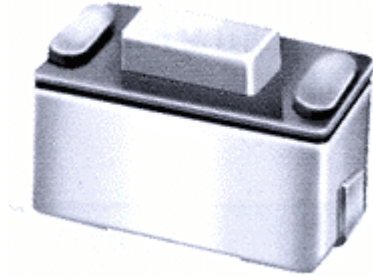

Typical Specifications

1. Rating : DC12V 50mA
2. Trave : 0.25 ± 0.1 mm
3. Operating Force : 130or180,250 \pm 50gf
4. Contact Resistance : 100m Ω Max.
5. Life : 50,000Cycles Min.

| Model no. | Knob(L) |
|-----------|---------|
| 1101NH | 4.3 |
| 1101NHA | 5.0 |

OUTLINE DRAWING

